

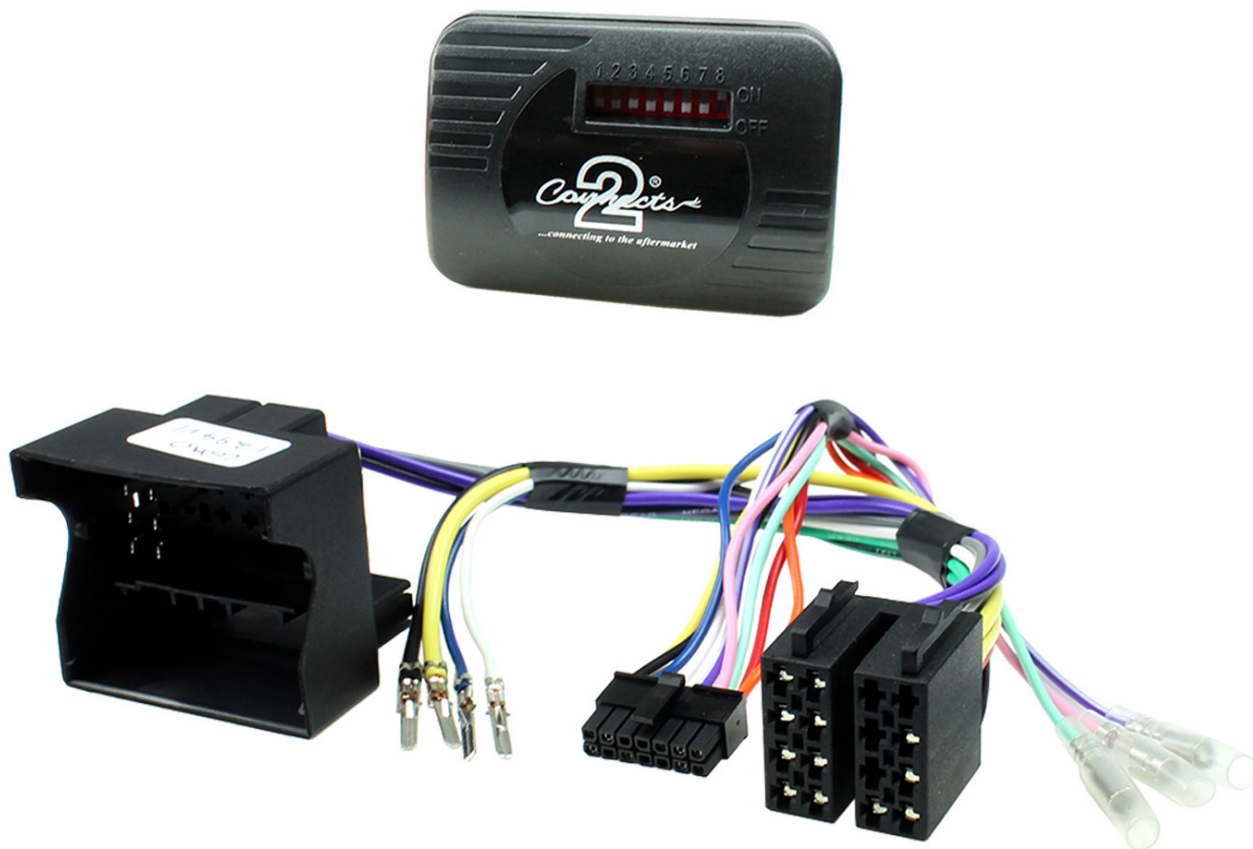

CT-QUAD-CAN

Universal ISO Harness

For Select CAN-Bus Vehicles
with Quadlock Connector



Designed and
Engineered
in the UK. 

APPLICATION

Note: Application data is subject to change at any time

For BMW, Citroen, Ford, Mercedes Benz*, Seat, Skoda, Peugeot and Volkswagen vehicles with CAN-Bus systems and OEM Quadlock connectors

For use with non-amplified vehicles only

*For vehicles with Audio20 head units and NTG2 system

FEATURES

- Provides an ISO connector for the installation of an aftermarket head unit
- Provides Illumination, Accessory, Speed Pulse, Park Brake and Reverse Gear outputs

DISCLAIMER

The information provided in this document is subject to change without notice due to manufacturer changes and/or improvements to the product/s. This instruction manual is based on documented data and research. The manufacturer of this product cannot be held responsible for any changes made to the vehicle by the manufacturer or damages that may occur through the installation of this product in accordance with the steps outlined herein.

PRIOR TO INSTALLATION

Read the manual prior to installation. Technical knowledge is necessary for installation. The place of installation must be free of moisture and away from heat sources. Please ensure that the correct tools are using during the installation to avoid damage to the vehicle or product. Connects2 can not be held responsible for the installation of this product.

WIRING KEY

Before installation into the vehicle, wire up the Quadlock connector with the CAN +, CAN -, +12V and Ground wires according to the vehicle manufacturer.

FORD/SEAT/SKODA/VOLKSWAGEN

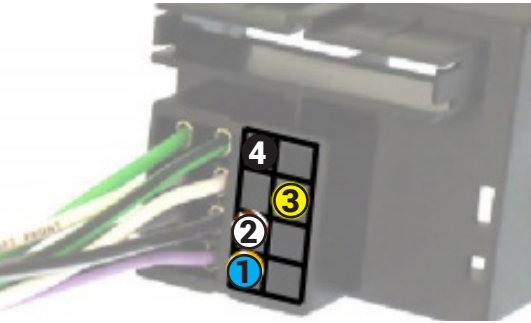

BMW/MERCEDES

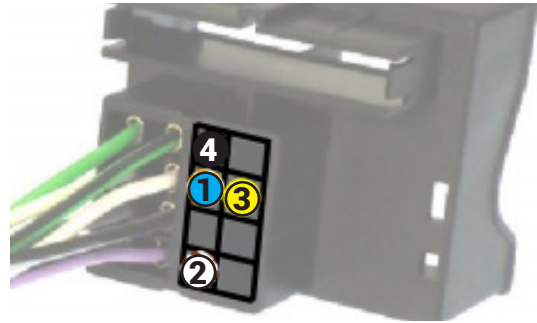

CITROEN/PEUGEOT

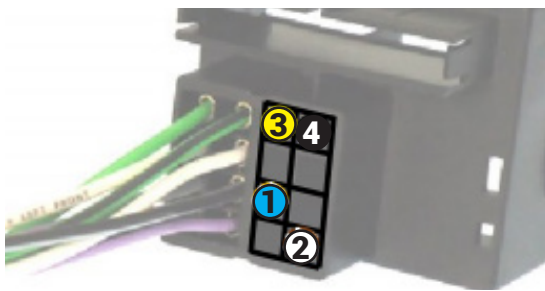

Key

- ① CAN + (Blue)
- ② CAN - (White)
- ③ 12V (Yellow)
- ④ GND (Black)

DIP SWITCH SETTINGS

In order to ensure that the interface functions correctly, before installation, set **DIP switches 1 - 8** as below according to the vehicle manufacturer.

	1	2	3	4	5	6	7	8
BMW	●	●	○	●	○	●	●	○
CITROEN	○	●	○	○	●	●	●	○
FORD	○	●	○	●	●	●	●	○
MERCEDES BENZ	●	○	●	●	●	●	●	○
SEAT	●	●	○	○	●	●	●	○
SKODA	●	●	○	○	●	●	●	○
PEUGEOT	○	●	○	○	●	●	●	○
VOLKSWAGEN	●	●	○	●	●	○	●	○

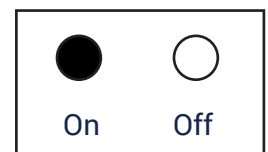

INSTALLATION GUIDE

Before installing the interface, the factory stereo must be removed and disconnected. To do this, please consult the vehicle owner's manual/handbook or contact a fitting professional.

1. Configure the Quadlock connector wiring and DIP switch settings as required for the vehicle application (see 'Wiring Key' and DIP Switch Settings' - Pg. 2).
2. Connect the main wiring harness to the interface box via the 14 pin molex connector.
3. Connect the Quadlock connector to the OEM vehicle connector.
4. Connect the ISO connector to the stereo.
5. Connect any required flying wires from the main wiring harness to the vehicle to retain features (eg. speed pulse, park brake etc)

Outputs

Speed Pulse	Pink	Illumination	Orange
Reverse Gear	Purple/White	Accessory (Switched 12V)	Red
Park Brake	Green		

6. Make sure all connections have been established and then turn on the ignition to test for correct operation.

CONNECTION DIAGRAM

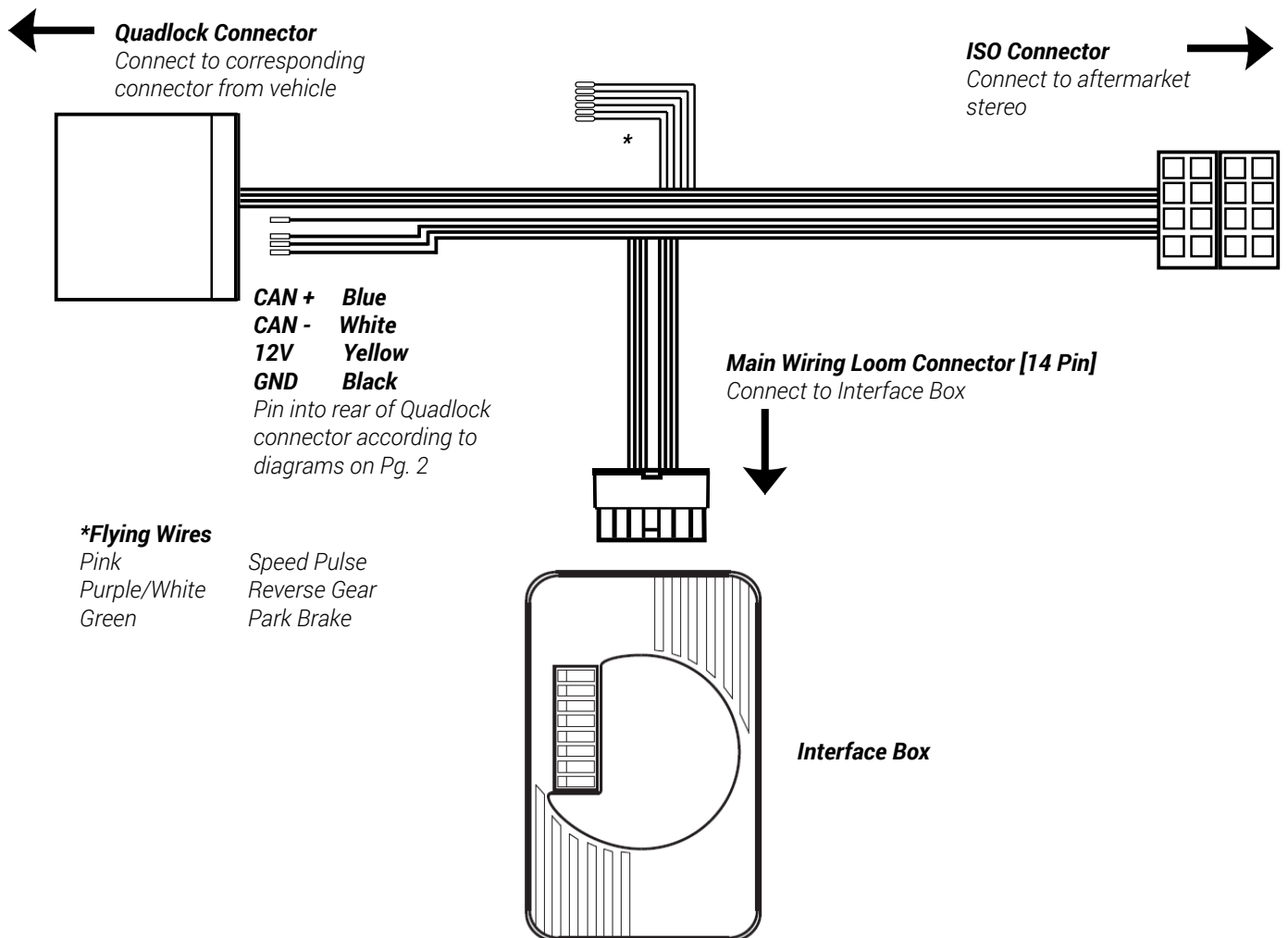

Need help? Visit support.connects2.com/tickets/technical

NOTES
